

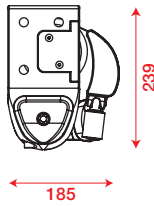

## Dimensioni della tenda chiusa \*\*

installazione a parete / soffitto / nicchia



inclinazione minima 3°

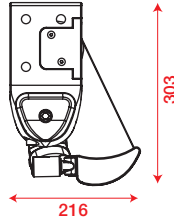

inclinazione massima 85°

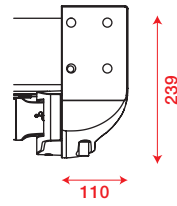

vista posteriore

## Staffe \*\*

installazione a parete

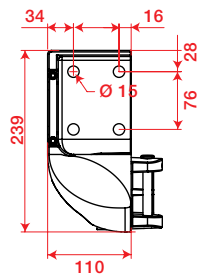

installazione a soffitto

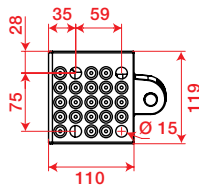

installazione a nicchia

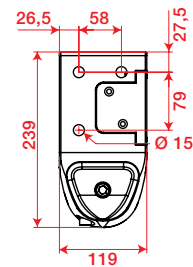

## Ingombri minimi

NUMERO BRACCI

2 BRACCI

SPORGENZA BRACCIO	2 BRACCI	
	165	195
215	245	
265	295	
315	345	

## Lunghezza del braccio e inclinazione

installazione a parete / soffitto / nicchia

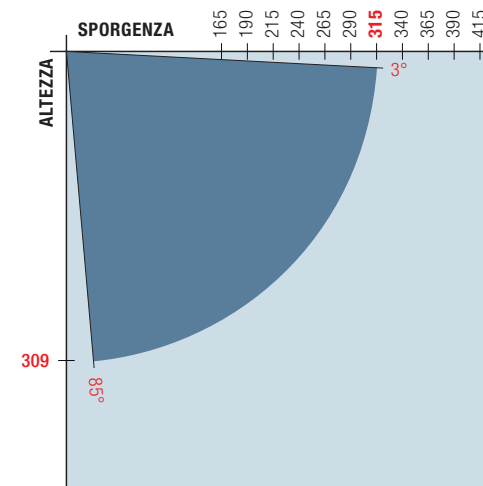

## Caratteristiche tecniche

